



PINTLALA HISTORICAL ASSOCIATION



C/O PINTLALA PUBLIC LIBRARY
175 FEDERAL RD.
HOPE HULL, AL 36043

Volume 2, Number 3

July, 1988

OFFICERS

| | | |
|-----------------------|----------------------------|----------|
| President..... | Ethel Tankersley Todd..... | 288-3225 |
| Vice-President..... | Jim Edwards..... | 288-0840 |
| Secretary..... | Manie Sellers..... | 279-9313 |
| Treasurer..... | Ricky McLaney..... | 288-1057 |
| Parliamentarian..... | Gary Burton..... | 288-7414 |
| Members-at-large..... | Moses Sellers..... | 288-4626 |
| | George Mosley..... | 264-7614 |
| | Julianne Hataway..... | 281-4338 |
| | Jack Hornady..... | 265-5752 |

JULY MEETING - July 17, 1988, 2:30 P.M. Pintlala Baptist Church

Program: FLETA DAY - Jim Edwards, Vera Kraus, Hattie Smith

NOTES FROM THE PRESIDENT:

Congratulations to Pintlala Baptist Church on completion of the Scott Wing and Sam and Lora Whigham Hall. The new addition is beautiful and an asset to the Pintlala Community. The members of PHA who have difficulty with steps will be especially thankful for the ground-level building.

Ricky McLaney has given us interesting information on the life and career of Dr. Thomas Benton Sellers, son of Joseph Samuel and Lurenda Carter Sellers. This information is on file at the library and will be on display at the July meeting.

Thanks to Pattie Moseley for a sweet note of encouragement. I agree with her that her late husband, Rev. Franklin Shackelford Moseley (who did extensive and accurate research on the Moseley family) would have loved being a part of PHA.

A great write-up on family reunions was in the Advertiser May 1, 1988 with pictures about the Shackelford-Moseley reunions going back to 1930. A copy will be on display. Perhaps George Mosley will be able to identify some of the people. I hope, too, he will report on the June 25, 1988 reunion.

Thanks to Dorothy Samuel for another sweet and encouraging note. She has given us for the files a pedigree chart on the Leslie Samuel family and a group sheet on Eleazor Anderson. Laurie Sanders will have copies of a 1901 map showing Hope Hull as McGehees, Pintlala as Killough, and Fleta as Union Academy. She will also have an undated map of, supposedly, T14, R17. We will welcome interpretation from any map experts. As Laurie says, "it looks like Greek to me."

Nagging time: There is a poem (I can't recall author or much of poem) that starts:

"I meant to do my work today.
But a brown bird sang in the apple tree"

If you have meant to send in your dues, please do.

We need to get in reports on Areas of Interest - even if partially completed. I put myself at the head of the dilatory list. I have done little on doctors and less on my family history.

Lurline Hall has worked hard on the files at the Library and they are in good shape. The problem is - they are not being used. What can we do to make it easier for you to enjoy them? E.T.T.

LIBRARY HOURS: The Pintlala Public Library is open on Wed, Thu, and Fri 1:30 - 4:00 PM and Sat 9:00 - 11:00 AM.

QUERIES: Correction on Mr. Green's query from last quarter. It should have read: Is there a Liberty Cemetery in this section? We had printed 'Liberty Community'.

(over)

July 1988

APRIL MEETING: (Excerpts from minutes). There were 32 persons attending the meeting. The treasurer reported a balance on hand of \$813.94 with 60 families having renewed membership for the current year. Ricky McLaney reported that the new 4 drawer file cabinet and folders have been installed at the library. The Highway Department responded to the request to change the spelling of Davenport to Devenport by stating that it is shown as Davenport on a 1900 map and that there was a store front with the name so spelled. Susan Brown introduced Mrs. Susan DuBose who is Curator of Education at the Alabama Archives and History. Mrs. DuBose gave a very informative slide program and talk about the information available at the Archives and the efforts which are being made to preserve the artifacts and documents which make it possible for us to reconstruct our family and community history. M.M.S.

MRS. LORA BOYD WHIGHAM'S PROPERTY

Thanks to Mrs. Lora Boyd Whigham for allowing us to précis the abstract of her home and lands located on Federal Rd. near the Lowndes Co. line. Of particular interest are copies of two letters - one from Mrs. Mamie Thorington and one from Mrs. Jesse Reynolds - written in 1942. Quote from Mrs. Thorington:

'I regret to say I cannot find out from any one when the house was built. I have traced back through the abstract office the different parties who at various times have owned the Boyd place. It is really quite interesting. There have been three noted men in Alabama history who have at different times owned the place. One of these was Governor Thomas H. Watts, who owned it in 1853; another was Colonel Hillary A. Herbert, Secretary of the Navy in Cleveland's administration, 1st and only Alabamian to occupy seat in the Pres. Cabinet who owned it in 1867; and Mr. W.L. Chambers, the first Provisional Governor of the Samoan Island after they were taken from Spain, who owned it in 1880.

'The property was bought from the government in 1817 by a gentleman named Mr. Wade Allen, whose daughter married Thomas H. Watts. Since it was bought from the Government in 1817 and owned by Governor Watts in 1853 we can safely assume that at some time between those two dates the house was built. It will be natural to suppose that Mr. Wade Allen built it sometime after he bought it in 1817. As it is undoubtedly a very old house and closely resembles other old homes built by slave labor we can safely say it was built at that time.

'Mrs. Boyd says the house is put together with pegs instead of nails. She will give you one of the pegs to show and she will also give you a sample of the floor to show that it is hand hewn. The hinges are also hand made.'

The following information about Governor Watts is from a pamphlet Governors in Alabama published for Newspapers in Education by Alabama Journal-Advertiser Co.

'Thomas Hill Watts was the last Confederate Governor of Alabama, fleeing the capital ahead of the advancing Federal troops which invested the city of Montgomery in April 1865. He was born on January 3, 1819 in Butler County, Alabama Territory, the second native-born Alabama governor. He was educated at Airy Mount Academy and the University of Virginia. He practiced law in Greenville, Alabama and later in Montgomery. He represented both Butler and Montgomery Counties in the state legislature. Watts was one of wealthiest men ever to hold office of governor, but at the end of the war he was virtually penniless. For five months he served as attorney general in Jefferson Davis' cabinet, and in December, 1863 took office as governor. As was the case with other Confederate officials, Watts was incarcerated by the Federal government for a short time after the war. He was twice married. First on January 10, 1842 to Eliza B. Allen, and second to Ellen Jackson in September, 1875. He had six children from the first marriage and none from the second. His last public service was as a member of the Alabama House of Representatives in 1880-81. He died in Montgomery on September 16, 1892.

FAMILY TREES: Mr. and Mrs. J.C. Fitzpatrick, Jr., 4780 Kingsdown Rd, Dunwoody GA 30338 have the following names on their family trees: Fitzpatrick, Tracy, Jardine, Clark, Woltersdorf, Hyde, Gorman, Healy, McDowell Watkins, Mullins, Blake, McCrorey, Crawford, Adger, Yongue, Gamble, McKain, Arnett, Reynolds, Vaughan, Turner, Harrison, Tatum, Potter, Parmer, Hubert, Hill, Harris, Moseley, Westbrook, Vann, Waddill and Jeffrey.

Mrs. Mary Jo Athey Evans, 1307 Ski Lodge Apts. Montgomery, AL has Athey, Buckelew, Champion, Thrower, Lawrence, Whitworth, Fraser, Stoddard, Booth, Christian, Peck, Stowers, Steen, and Reynolds.

WARNING: Genealogical publications are again warning against the Family Books being offered by mail under several pennames. Mary B. Warren of Heritage Papers Press describes them as 'non-genealogies and out-dated telephone directories' and expresses concern that the postal service has not acted more directly to halt the mailing of this rip-off publication.

PROVIDENCE PRESBYTERIAN CHURCH, PCA
by Catherine Sellers

The story of the early settlers coming to Alabama traveling by oxcarts, mules and wagons, bringing with them their families, possessions, traditions and religious heritage is most interesting and has played an important role of the history of Providence Presbyterian Church. Among those who came from Mecklenburg, N.C. in 1821 were Messrs. William Sharp, known as Gentleman Billy and Zephanial Johns. These men of Irish descent settled on prairie soil in Montgomery County, Al. about 17 miles south of Montgomery in a rural area on the Old Hayneville Rd. known as Sharpville at that time.

Unfortunately early records of the church were lost and determining the date the church was organized has been a problem. The earliest records were expertly compiled from the memory of one of the early Elders, Capt. J.R. Dillard. However, the accurate date has been established by James William Marshall, author of The Presbyterian Church in Al. He lists Providence Church, Montgomery County, Al. as one of the new churches enrolling in South Alabama Presbytery in 1828.

The first house of worship, a log edifice, served as the meeting place for a small membership of pioneer families. Messrs. Johns and Sharp, the founding fathers, had to be instrumental in choosing the name. It is assumed that Providence was named after the old Providence Church established in 1768 that these men had left behind in Mecklenburg, N.C. The organizing minister was Rev. Robert Cunningham. The Sharp Cemetery where loved ones have been laid to rest is the only silent sentinel marking the spot where the first Presbyterian Church outside the city limits stood.

A new location about 5 miles east of the first site was selected for the location for building the second house of worship. Costly repairs to restore a deteriorating log building and the choice of a central locale for the resident members were factors determining this choice. In 1854, a building (described by Robertson in Recollections of Early Settlers in Montgomery County, Al. as "for a long time the finest church building in the county outside the city") was constructed of saved lumber with plastered walls and ceilings. The rear of the church was divided by a railing and there were two entrances in order to provide a place of worship for the slaves. As was the custom much in vogue during those days the pulpit was in the back of the church. It was from here the Rev. G. H. Whitfield, D.D. pastor of the First Presbyterian Church, Montgomery, Al. delivered the message of Dedication in 1854.

Faced again in 1895 with the cost of extensive repairs, after much deliberating the decision to move to the present location was approved. Mr. Hamilton McIntyre gave the acre of land for the building. It was under his personal supervision that the second house of worship erected in 1854, was torn down and rebuilt with few changes on the hill where it stands today. The plastered walls and ceilings were replaced with wood and wainscoting was added to enhance the decor. Slavery had been abolished at that time so the railing was no longer needed and two windows were put in place of the two doors. The pulpit was moved to the front.

The first service conducted in the rebuilt church was in Feb. 1896 and in July of that year the Rev. E.P. Davis, D.D. from the First Presbyterian Church in Montgomery presided over the service of Dedication.

160 years have passed since two men, strong believers in the doctrine of the Presbyterian Church, began in the community presently known as LeGrande a church that continues to stand as a beacon of light. Providence has been a part of Presbyterian Church in America since 1973, a church still true to the doctrinal standards that it was founded upon. Many families have paraded proudly across her pages of history. Some of the early names, pillars of strength, in addition to those previously mentioned are Malloy, Sankey, Dabney, Falconer, Robertson, Walter and Armistead.

Strength is not always found in large numbers. A statistical report for 1958 shows 83 communicant members, the largest on record. Today with a membership of 50, we find as always, our strength is in the Lord. A Sunday School program began in 1888 with other denominations participating. In fact the first two superintendents were Methodists, Messrs. David Livingston and Frank Lawrence. The story goes that the Presbyterians had no men who would pray in public at that time.

The ladies were first organized in 1926 and since that time have been an additional inspiration in all areas of the life and work of the church. Mission work has been a part of the work of the church as early as 1890 when a Mission woman in China was supported.

One minister, Rev. C.H. Rogers, served the church for 23 years. Two from the flock answered the call to serve in the ministry, C.E. Robertson and Fred Moore. One minister, Paul Long, Jr., left the church to do mission work in Portugal. Visiting missionaries have been welcomed in our midst on numerous occasions. Providence Church has hosted meetings of the Presbytery Group Conference, and held outstanding revivals and VBS.

In 1952, an educational annex including 4 Sunday School rooms and a kitchen became a reality. Rest rooms were added in 1957. Through the years a number of interior improvements, including beautiful brass chandeliers and matching sconces, chancel beautification, and refinishing the lovely old pine floors to the natural finish, make it a lovely sanctuary.

1988, the Year of the Olympics, a Presidential Election, Leap Year and even now the President is on a mission in Russia. Another major event took place worthy of mention. On May 29, Providence Church held a special service of Dedication of recent improvements and new furnishings, including painting the exterior of the building using a very complex method; new brick steps at the entrance to the annex; ornamental wrought iron railings with brass finials at both entrances; attractive lantern-type lamp hanging on front porch; new copper steeple and lighting of same; extensive remodeling in the annex including the kitchen area with all new furnishings; new chairs in the choir loft, blinds hung on the outside - replicas of the originals; Baptismal Font and other memorial furnishings, all presented by members of the church and dedicated to be used for His honor, glory and praise.

Rev. Vincent Rosato is presently leading the flock bringing dynamic messages each Sunday morning at 9:00 A.M. A Sunday School hour follows at 10:00. Weekly Bible Study is held each Wednesday at 7:00 P.M. WIC meets on the second Monday night monthly at 7:00 P.M. The doors swing wide to welcome all who choose to worship in this holy place.

Partial List of Ministers

Robert Cunningham, Organizing Minister
 A.N. Cunningham 1854-1887
 Theo Sayre
 P. McNab
 C.L.R. Boyd
 W.P. Harrison
 F. McMurray
 J.M. McKee
 S. McMillan
 William Swift
 R.M. Kirkpatrick
 J.C. Sturgeon
 G.R. Foster

 William White 1888-1891
 Sturgeon (again in 1892 until retirement)
 J. Elder 1908-1909
 M.J. McLean 1910-1913
 H.L. Snead 1913-1917
 C.B. Toomb 1917-1919
 C.H. Rogers 1919 'til Nov. 1941
 C.H. Webster 1941-1942
 Clyde Brown (Student) 1948-1919
 O.N. Hanby 1952-1958
 James Sommerville 1958-1960
 Andrew Bullard 1961-1966
 Bayes Clarke (Temporary Supply 1973, d. 2/26/73)
 Laurie Jones, Jr. (Stated Supply) 1973-1975
 Paul Long, Jr. 1976-1984
 Robert Hollingsworth 1978-1980
 David Gilleran 1981-1984
 Mike Lettering (Interim Supply 1984)
 Phillip Howell 1985-1986
 Vincent Rosato 1986

Partial Listing of Elders (before 1950)

C. Johns
 William Sharp
 Churchill Armistead
 William Malloy 1890
 J.B. Walter 1893
 Prof. B.B. Boyd 1899-02
 W.D. Sankey 1902
 J.T. Robertson 1902
 C.C. Sharpe 1928 - d.12-20-72
 W.V. Armistead 1934
 W.C. Hornady, Sr. 1938 - d.12-20-72
 C.M. Robertson d. 11-3-60
 T.M. Fowler 1949-59

Partial Listing of Deacons (before 1950)

C.E. Robertson
 J.T. Robertson 1890-94
 W.D. Sankey 1893
 J.A. Walter 1907
 P.M. McIntyre 1919-1951
 C.M. Robertson 1919-1960
 J.F. Hillman 1919
 C.E. Douglas 1929
 Frank Sankey 1929
 M.R. Walter 1938
 Knox McLaney, Jr. 1950-51
 J. Luther Mills, Jr. 1950-51

PLAT SHOWING LOCATION OF TOWNSHIPS AND RANGES WITHIN THE HUNTSVILLE AND ST. STEPHENS MERIDIANS, IN THE STATE OF ALABAMA.

Ranges are East and West of Meridian.
Townships are North and South of Base Line.

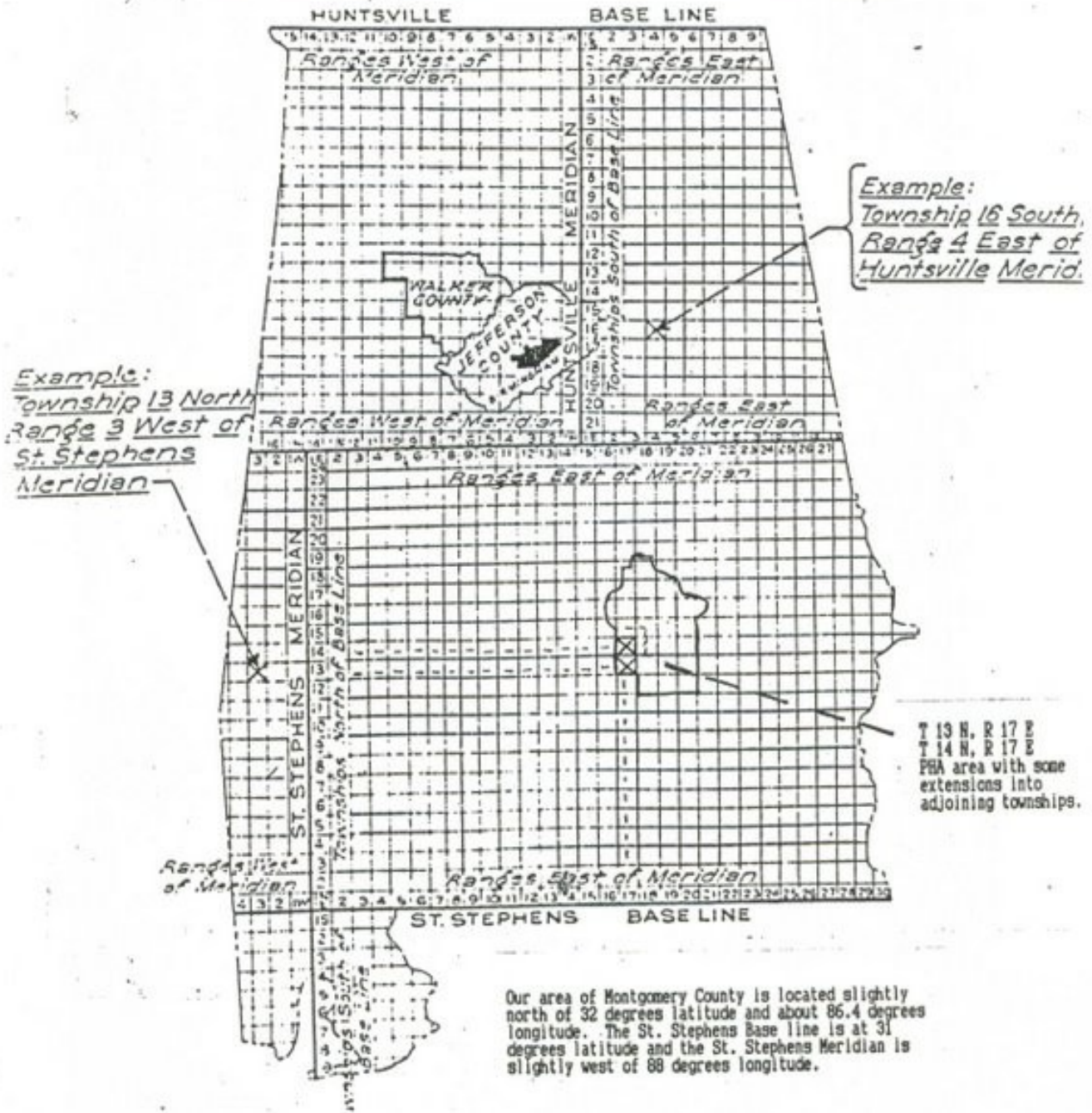

FRACTIONAL PARTS OF A SECTION

- MEASURES**
- 1 Link ----- 7.92 inches
 - 1 Chain ----- 100 links or 66 feet
 - 1 Acre ----- 208.71 x 208.71 feet
 - 1 Acre ----- 43,560 square ft.
 - 1 Section -- 1 mile to side
 - 1 Section ----- 640 acres
 - 1 Township ----- 36 sections
 - 1 Township -- 6 miles to side

- TERMS**
- NE $\frac{1}{4}$ -- Northeast Quarter
 - NW $\frac{1}{4}$ -- Northwest Quarter
 - SW $\frac{1}{4}$ -- Southwest Quarter
 - SE $\frac{1}{4}$ -- Southeast Quarter



PLAT OF TOWNSHIP SHOWING ARRANGEMENT OF SECTIONS, WITH ADJOINING SECTIONS

| | | | | | | | |
|----|----|----|----|----|----|----|----|
| 36 | 31 | 32 | 33 | 34 | 35 | 36 | 31 |
| 1 | 6 | 5 | 4 | 3 | 2 | 1 | 6 |
| 12 | 7 | 8 | 9 | 10 | 11 | 12 | 7 |
| 13 | 18 | 17 | 16 | 15 | 14 | 13 | 18 |
| 24 | 19 | 20 | 21 | 22 | 23 | 24 | 19 |
| 25 | 30 | 29 | 28 | 27 | 26 | 25 | 30 |
| 36 | 31 | 32 | 33 | 34 | 35 | 36 | 31 |
| 1 | 6 | 5 | 4 | 3 | 2 | 1 | 6 |

PLAT SHOWING ARRANGEMENT OF TOWNSHIPS AND RANGES IN REFERENCE TO MERIDIAN AND BASE LINE.

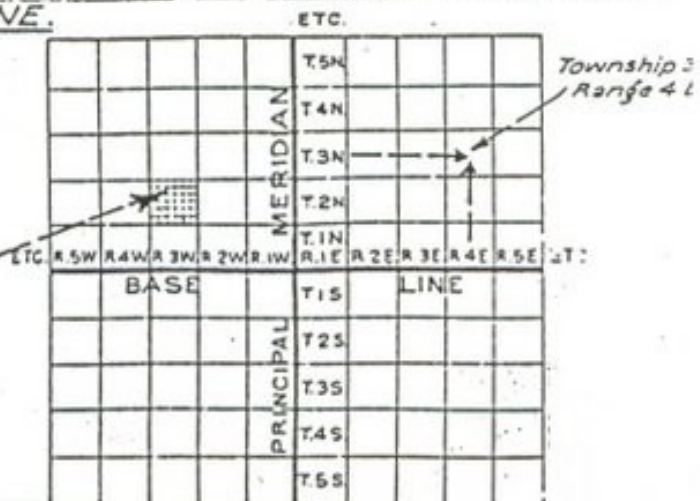

Congressional townships are not the same as civil or municipal townships, or towns, which vary in size and shape. Congressional Townships are 6 miles square and are made up of 36 sections of 1 square mile each (640 acres). Some sections in each township will contain slightly less than 640 acres to accommodate the curvature of the earth. Section 16 in each township was given to the state by the federal government to be used for the support of a school system. The placement and order of sections and townships is not affected by county lines, bodies of water etc. The stability of sections makes it easy to estimate mileage: 1 section = 1 mile; 1/2 section = 1/2 mile etc.

CORRESPONDENCE: We appreciated a letter from H. David Mosley outlining his family's Pintlala connections.

My family members are Henry David Mosley, Helen Frazer Mosley, Mary Mosley Mansour, daughter of Helen and David Mosley, Robin Shackelford Mosley, formerly Robin Wright Bowman, now the legally adopted daughter of Helen and David Mosley. Mr. and Mrs. John Hendricks and their son Chad Eric. Mrs. Hendrix is daughter of Mary Mansour, and our granddaughter. Chad Eric is our great grandson. My father and mother were Franklin McLemore Mosely and Lela Shackelford Mosley. Both were born and grew up in Pintlala. Helen's father and mother were George Stanley Frazer and Mary Williams Frazer. I hope that Helen, Robin and I can be active in the Association. The above information is sketchy, but my association with Pintlala has been pleasant and long. I still remember my first trip to Pintlala in a horse and buggy, approximately 74 years ago

We also acknowledge the nice notes from Mr. Edward L. Mosley of Atlanta and Dr. and Mrs. George Sustental of New Orleans. Your encouragement is gratifying.

DID YOU KNOW?: The area on Pettus Road south of the intersection with Route 31 is known as "Egypt" or "Little Egypt". Do you know the origin of the name? Did it derive from the name of one of the earliest settlers - the Pharoah family?

Do you have a "did you know" or other anecdote or bit of history? Let us have it in writing for the newsletter!

NEW MEMBERS WELCOME:

A sincere welcome to the following new members: Mr. and Mrs. Sam Whigham.

In the interest of acquiring new members we will send a complimentary copy of the newsletter to families who may wish to join PHA. You can help by giving us names and mailing addresses for those who may be prospective members - addresses not limited to local area.

1988 dues now OVERDUE. New members please complete the membership form.

MEMBERSHIP APPLICATION

Pintlala Historical Association
c/o Pintlala Public Library
175 Federal Road
Hope Hull, AL 36043

\$5.00 registration fee + \$5.00 annual dues.
Note: All members of a household are included.

Mr., Mr. and Mrs., Mrs., Ms. _____

Other household members: _____

Address _____

City, State, Zip _____

Phone (home) _____ (office) _____

Interest Areas: _____

If you are interested in genealogy please indicate family surnames _____
